

# flippin' <sup>®</sup> FROG XL<sup>®</sup> Operation Manual

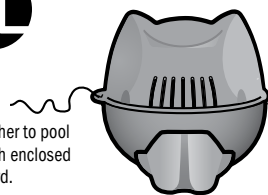

Tether to pool with enclosed cord.



Flippin' FROG XL<sup>®</sup> sanitizing mineral pool care will help destroy bacteria to keep your pool clean with less work and up to 50% less chlorine.\*

It is super easy to use and will keep you enjoying a clean, clear swimming pool for weeks at a time.

Active Ingredient:  
Silver Chloride ..... 0.5%  
Other Ingredients: ..... 99.5%  
Total: ..... 100.0%

## KEEP OUT OF REACH OF CHILDREN CAUTION

**Directions For Use:** It is a violation of Federal law to use this product in a manner inconsistent with its labeling. For use in above ground or in-ground pools between 5000 and 10,000 gallons. Not recommended for pools under 5000 gallons. Ensure all pool equipment is working properly with adequate circulation per the pool manufacturer. Balance the water's Total Alkalinity to 80-120 ppm and pH to 7.2-7.8. Shock pool to remove contaminants (follow manufacturer's directions).

For complete instructions read the entire manual

## Step 1: Preparing the Pool

1. Make sure the pool has adequate circulation. The total volume of pool water must completely circulate through the pump and filter at least 1 to 2 times per day. This usually requires 8 to 12 hours of circulation. Check with your dealer for the proper circulation time for your pool.
2. Check the pool's filter gauge often and periodically clean the filter per the manufacturer's directions. A dirty filter will slow the flow of water which could hamper proper circulation.
3. Check the Total Hardness of your fill water before adding to the pool. If calcium content is higher than 400 ppm find a soft water source to fill your pool instead; otherwise water balance will be very difficult.

## 4. For best results in achieving water balance, follow steps a through e in order.

**IMPORTANT:** Always follow printed instructions on the balancing chemical packages. Add balancing chemicals in small increments one at a time with circulation running. Wait 8-12 hours before testing again and adding any additional balancing chemicals.

### Water Balance Guidelines

pH:	7.2 - 7.8
Total Alkalinity:	80 - 120 ppm
Total Hardness:	200 - 400 ppm
Total Dissolved Solids:	<1500
Stabilizer/Conditioner:	20 - 80 ppm
Free Chlorine	0.5 - 1.0 ppm



**a.** Take a water sample from the pool and dip a FROG<sup>®</sup> Test Strip into it.

**b.** Look at the **Total Alkalinity** reading first. Adjustments should be made to bring the Total Alkalinity in the **range of 80 - 120 ppm** prior to making any adjustments to pH even if it throws pH off further.

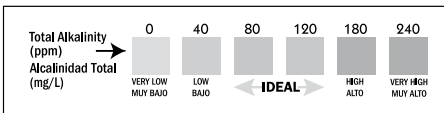

**c.** After Total Alkalinity is in range, **test for pH**. It should be **between 7.2 and 7.8**. If higher or lower, add a pH adjuster.

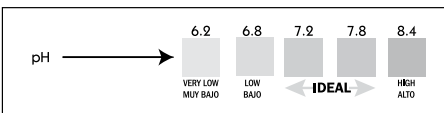

**d.** Then test for **Total Hardness** again. It should be between **200 and 400 ppm**. If lower than 200 ppm, add Calcium Hardness Increaser.

**e.** Lastly, test for **Stabilizer or Conditioner levels**. Add conditioner if the level is below 20 ppm. This will prevent chlorine burn off. If stabilizer level is above 80 ppm, partially drain water and refill.

If balancing takes longer than 2 days, shock the water and maintain a chlorine level while continuing balancing.

5. If you haven't already added a shock during balancing, initially shock the pool with a chlorine shock only to remove contaminants and establish a chlorine residual. Always follow the manufacturers' directions carefully. **NOTE: THIS STEP IS VERY IMPORTANT TO START-UP. USE CHLORINE SHOCK ONLY.**



### IMPORTANT

Never add any types of chlorine, pH adjusters, shock treatments or algaecides through the skimmer or within 3 feet of Flippin' FROG XL. Damage to the pool or equipment, fire or explosion could result.

## Step 2: Putting the System to Work

1. Remove outer packaging from both the mineral and chlorine cartridges of the Flippin' FROG XL. NOTE: Small mineral particles may have dislodged from the cartridge in shipping. Simply discard particles in trash.

2.

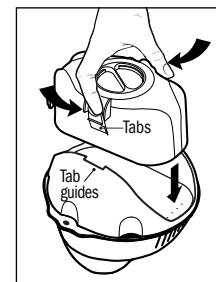

Align the chlorine cartridge with tab guides on the mineral cartridge. Push together until you hear the cartridge click into place.

3.

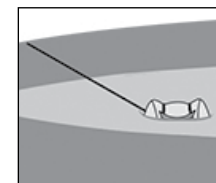

Tether it to the pool side with the cord provided, away from the skimmer or a return jet. More than 1 system can be used for larger pools (for instance 2 Flippin' FROG XL for up to 20,000 gallons).

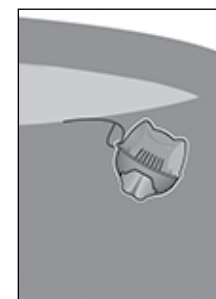

**NOTE:** This product may be removed from the pool when in use. Lift out of the water and let drain into the pool. Then hang over the outside of the pool or place on the ground or a surface that is not susceptible to bleaching from the chlorine. Remember to replace the product once exiting the pool.

## Replacing the Cartridges:

a.

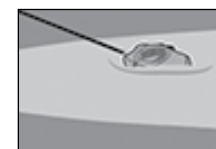

When the product is almost empty, it will slowly flip over giving you notice that it's about time to replace.

b.

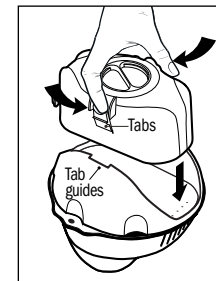

Do not remove the chlorine cartridge until the system has completely flipped.

When it completely flips over, release the chlorine cartridge by squeezing the tabs and pull the empty cartridge out.

## Step 2 (continued)

**c.**

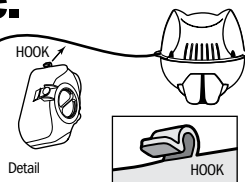

If the chlorine cartridge contains a small amount of chlorine after the system has flipped over, hang on the tether via the hook on the side of the cartridge until completely empty. Do not allow chlorine cartridge to sink to the bottom or pool bleaching may occur.

**d.**



When completely empty, discard in trash or offer for recycling if available.

## Step 3: Setting the Dial

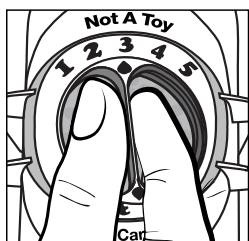

Twist the dial on the chlorine cartridge to the setting number for your pool size (see Setting Chart). If you find less chlorine is needed, turn the dial to a lower setting. If more is needed turn to a higher setting. Even at the lowest setting there will be some chlorine released into the pool.

### Initial Setting Chart

Gallons	Setting #
5,000	1
6,000	2
7,500	3
9,000	4
10,000	5

**NOTE:** Calculate pool gallons for round pools by multiplying **diameter x diameter x water height (feet) x 5.9**. For rectangle pools multiply **length x width x average depth (feet) x 7** or visit our pool-volume calculator at [frogproducts.com](http://frogproducts.com).



**Manufactured for King Technology, Inc.**  
6000 Clearwater Dr, Minnetonka, MN 55343 U.S.A.  
800-222-0169 | [frogproducts.com](http://frogproducts.com)

**Register your Flippin' FROG XL at [frogproducts.com](http://frogproducts.com)**  
Learn more at [frogproducts.com](http://frogproducts.com) or call 800.222.0169

\*Compared to the minimum EPA recommended chlorine level of 1.0 ppm for a stabilized swimming pool.

Assembled in USA  
Patents: [kingtechnology.com/IP](http://kingtechnology.com/IP)  
EPA Est. No.: 64114-MN-001

E03250126R3 20-48-0104



Escanear para  
manual en español  
y de datos de  
seguridad

## Step 4: Routine Pool Care

**1.**



Run pump and filter at least 8 hours per day but ideally 24 hours per day. Clean or replace your filter cartridge weekly. Lack of circulation may cause bleaching of pool surface and improper sanitization levels.

**2.**



Skim the surface of any debris and remove anything collected on the return fitting to your pump.

**3.**



Regularly test water for pH, Total Alkalinity and chlorine levels. Adjust your pH when it rains or when adding fresh water to the pool. Maintain a 0.5 - 1.0 ppm chlorine level at all times.

**4.**

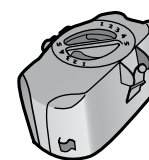

Replace the chlorine cartridge when the Flippin' FROG XL completely flips over.

**5.**



Shock the pool at least weekly when the pool is being used often and every few days when the water temperature is 90 degrees or more to maintain water clarity. We recommend a non-chlorine shock as reducing chlorine use is the goal of FROG products. However, using a chlorine shock is OK too. See IMPORTANT box under Step 1: Preparing the Pool.

**6.**



Replace the complete Flippin' FROG XL every six months or after one pool season whichever is shorter. If the pool is drained and refilled prior to six months, the Flippin' FROG XL must be replaced at that time.

## Troubleshooting

### Cloudy Water or Low Chlorine Levels

**1.**

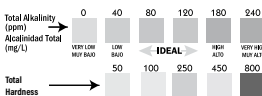

Check water balance. Ensure pH, Total Alkalinity, Total Hardness and Stabilizer levels are correct.

**2.**

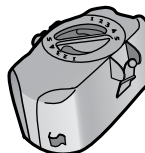

Check chlorine cartridge and replace if empty—see instructions under Replacing Cartridges.

**3.**



Make sure your mineral cartridge is not older than 6 months as it will be ineffective, and more chlorine will be required to maintain the pool until you replace the minerals.

**4.**



Shock the pool with a chlorine or non-chlorine shock to regain clarity. See Step 1: Preparing the Pool.

### High Chlorine Levels

**1.**



Remove Flippin' FROG XL from the pool until the chlorine level is down to 1.0 ppm.

**2.**



Lower the dial setting by 1 number and replace in the pool.

**3.**



Test in 24 hours. Repeat process until chlorine level stays within 0.5 to 1.0 ppm.

### Algae

**1.**

Use FROG Algae Gone™ following manufacturer's directions carefully. This may involve more than one dose.

**2.**

Run circulation 24 hours a day and brush the sides of the pool often.

**3.**

When clarity starts to return, shock the pool. See Preparing the Pool.